

Model :

EIH3-01

Service Manual

Induction hob

Technical data

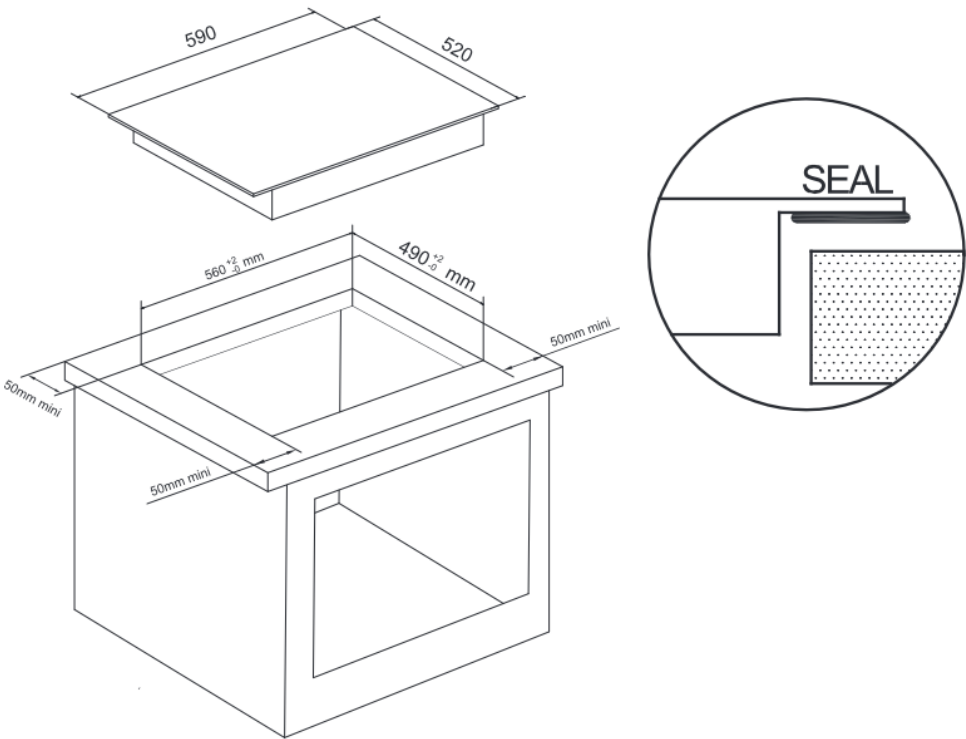

Model : EI H3-01

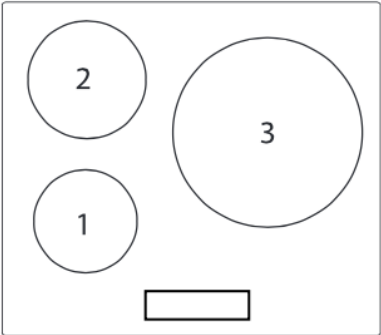

Heating zone	Size (mm)	Normal
1	Ø 140	1500 W
2	Ø 180	2000 W
3	Ø 280	3000\3600W

Voltage : 220-240V~

Frequency: 50/60Hz



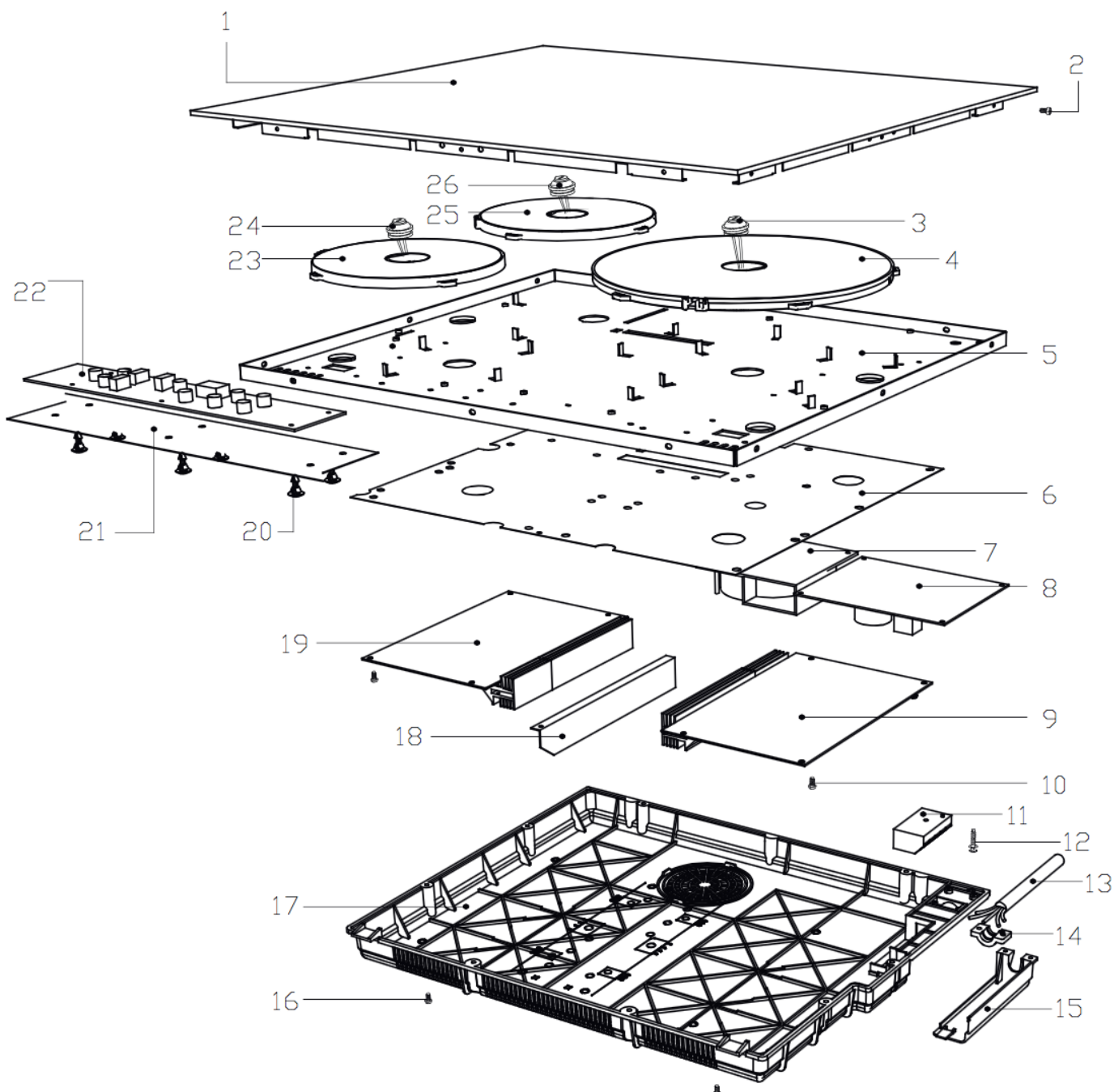

1

Exploded view

Model : EIH3-01



No.	CODE	Q'ty	COLOR	
-----	------	------	-------	--

30	303206800036	2	RED/450mm	
31	303206800041	2	RED/150mm	
32	303206800159	2	RED	
33	303206800157	2	BLUE	
34	303206800158	1	YELLOW/GREEN	

2

Spare part list

Model : EI3-01

No.	Parts code	Parts names	Series No.
1	G-EI3-01	glass assembly	
2	301500101374	Screw	
3	303208101074	the ceramic plate temperature sensor	
4	542300300002	303203501153 280 Coil groupware	
		542200000010 180 Coil groupware	
5	541400300002	radiator board	
6	303207103157	isinglass flake B	
7	303208003019	Fan	
8	303203101365	accessorial power	
9	303203101394	Power board	
10	301500101197	Screw	
11	303207801038	junction port holder	
12	301500101200	Screw+gasket	
13	303203601114	Power Cord	
14	303207300213	fixed board	
15	303207300214	power cord case cover	
16	301500100954	Screw	
17	303207300216	Base	
18	303207300215	windshield insulating flake	
19	303203101364	Power board	
20	303207300211	knighthead	
21	303207103155	isinglass flake A	
22	303203101494	Display board	
23	303203501155	140 Coil groupware	

24	303208101074	the ceramic plate temperature sensor	
25	303203501117	180 Coil groupware	
26	303208101087	the ceramic plate temperature sensor	

3

Technical data

Model : EIH3-01

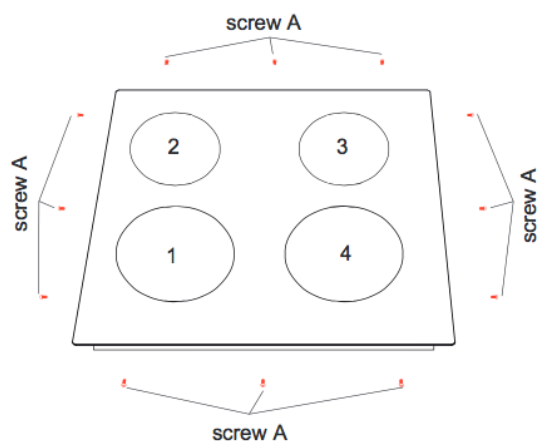

Step1:
remove the screw A around the base cover

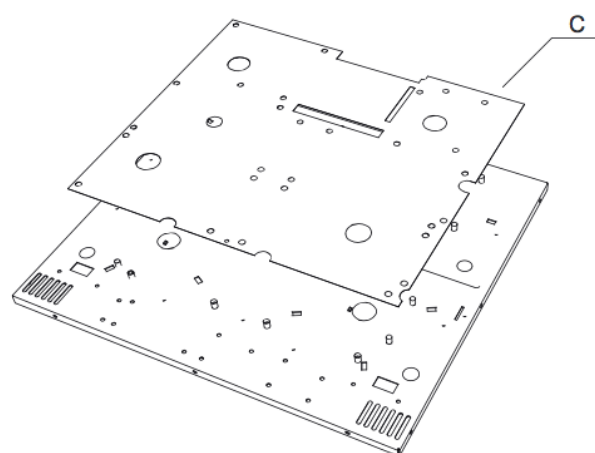

Step 4:
Remove C

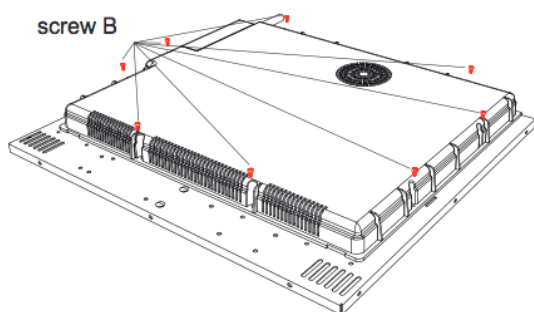

Step2:
remove the screw B

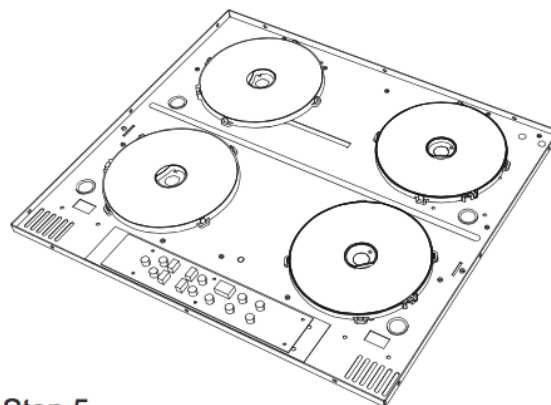

Step 5:
reserve the product

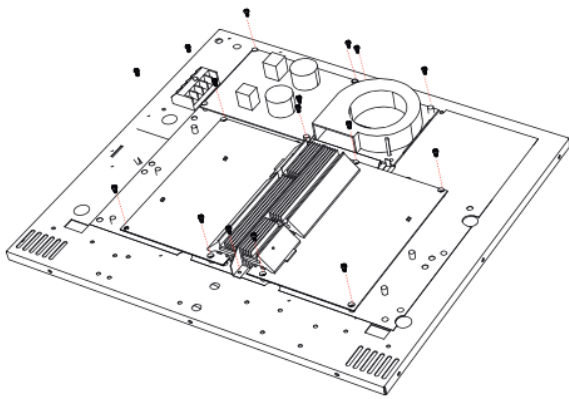

Step 3:
remove all the screws and wires

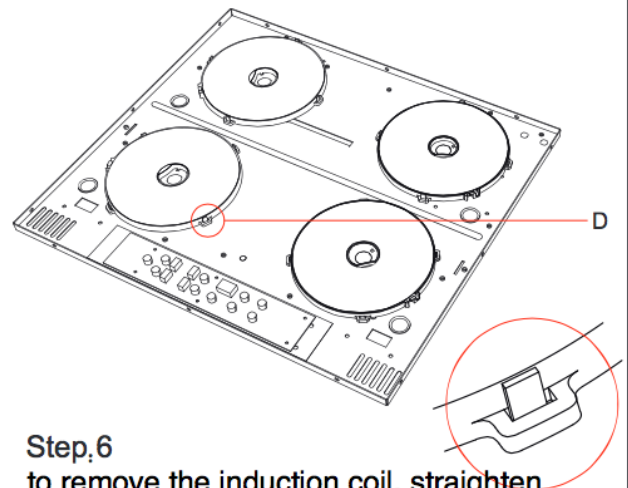

Step 6
to remove the induction coil, straighten
the buckle of D

4

Technical data

Model : EIH3-01

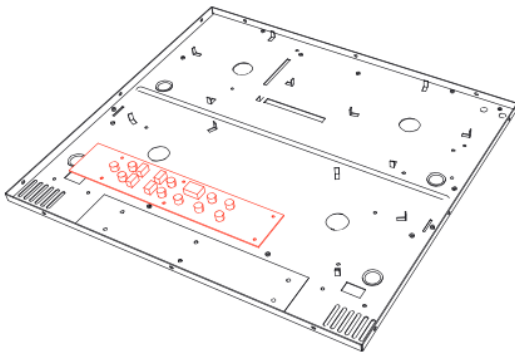

Step 7:
remove the display board

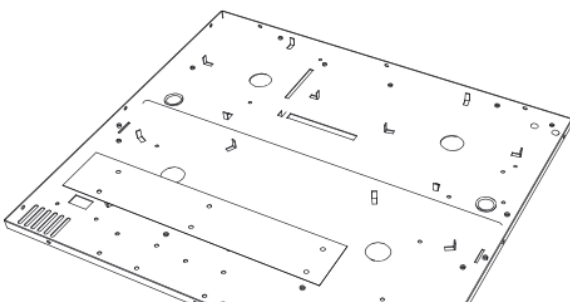

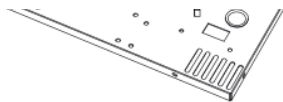

Step 8:
done

5

Technical data

Model : EIH3-01

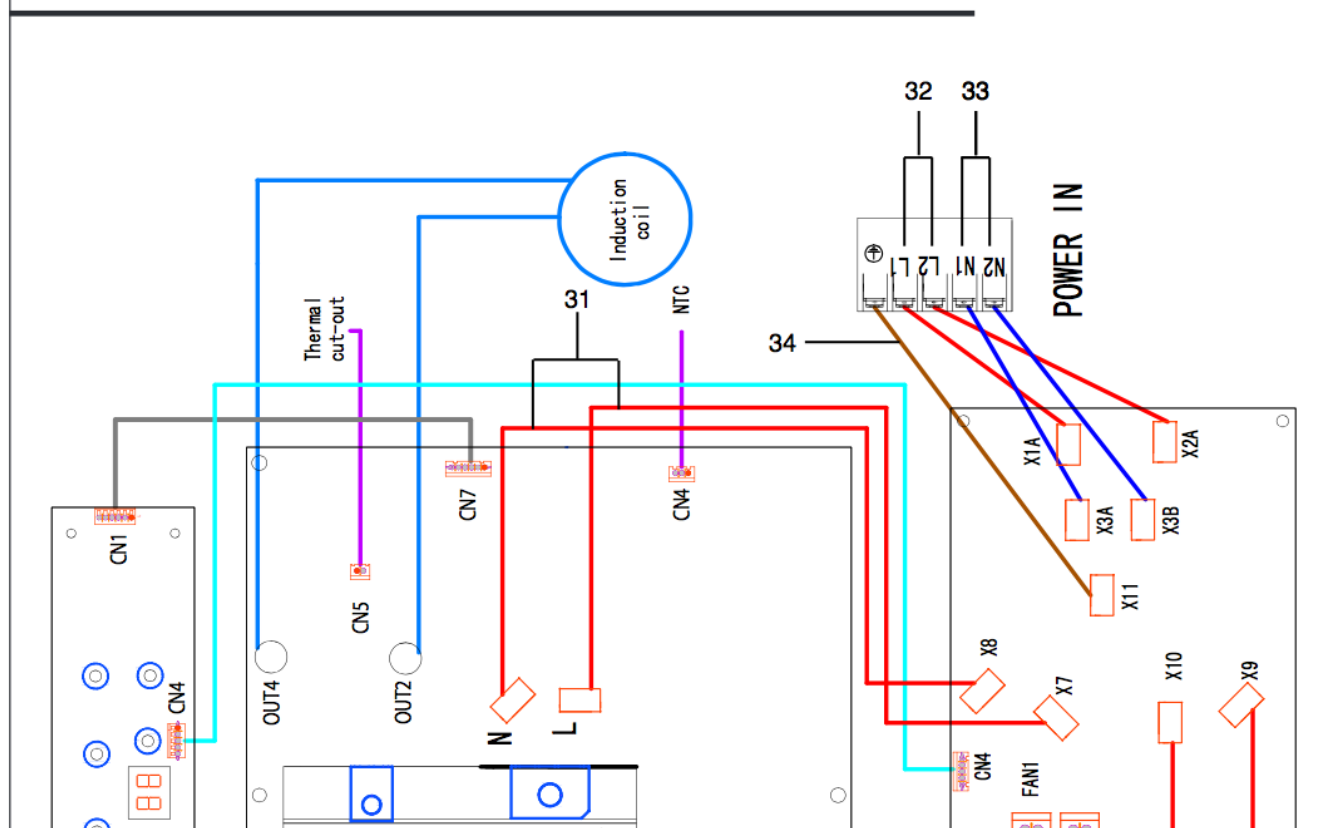

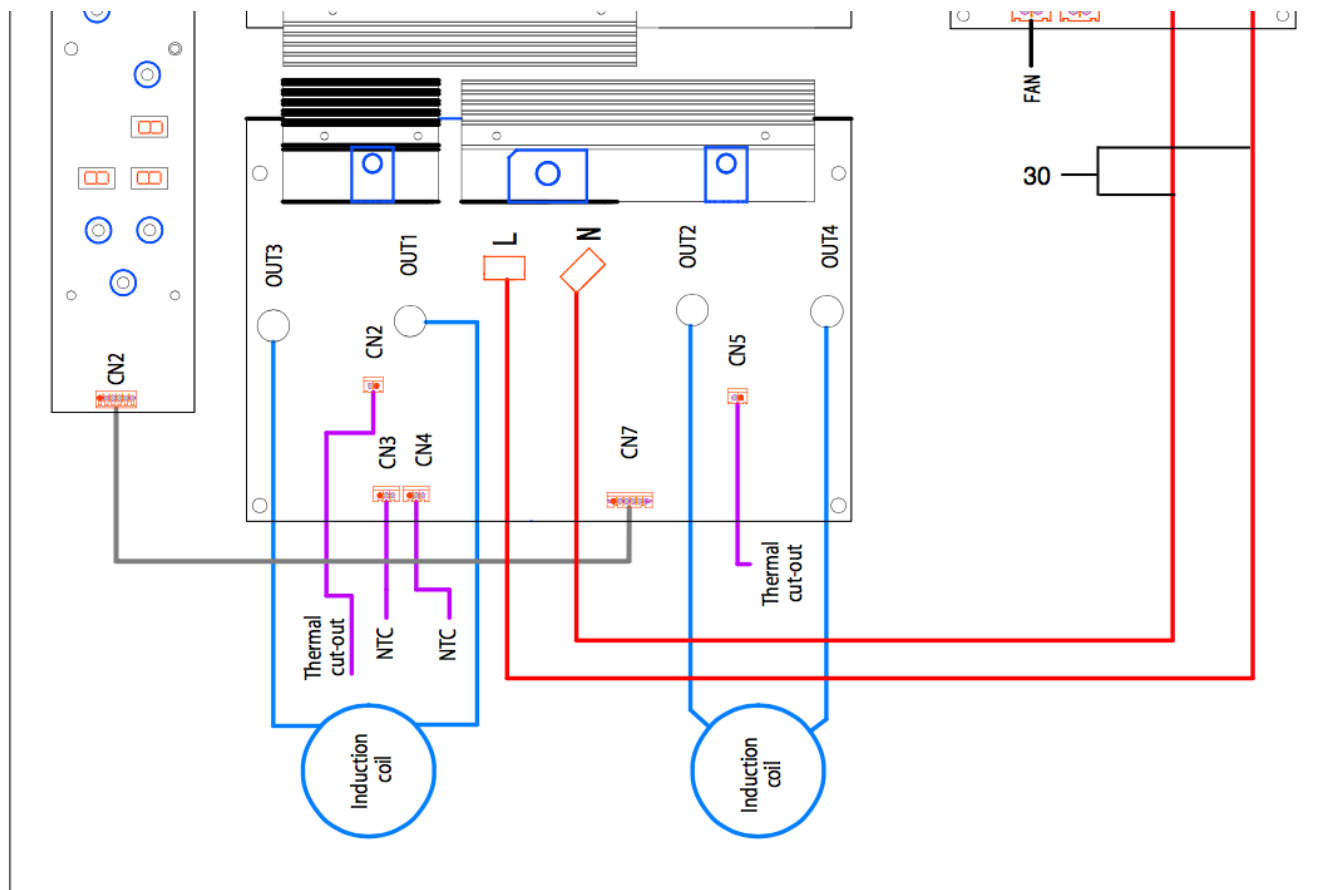

6

The induction hob is equipped with a self diagnostic function. With this test the technician is able to check the function of several components without disassembling or dismounting the hob from the working surface.

Troubleshooting

- 1) failure code occur during customer using.
- 2) Solution a is as following.
- 3) If the problem can't be settled by solution a, solution b can be used.

Failure code	Problem	Solution
E1/E2	Voltage irregularity.	Unit should operate normally after a few minutes and code will disappear from display.
E3/E4	High temperature of ceramic plate	Wait for temperature to return to normal. Push "ON/OFF" button to restart unit.
E5/E6	High temperature of hob	Wait for temperature to return to normal. Push "ON/OFF" button to restart unit. Check if the fan runs smoothly. Fan should be replaced by a new one if not work anymore.
F3/F4/F5/F6/F7/F8	Ceramic plate temperature sensor failure.	Check the connection or replace the ceramic plate temperature sensor.
E9/EA/EB/EC/ED/EE	IGBT temperature sensor failure	Replace the power board

LED temperature sensor failure. Replace the power board.			
Failure	Problem	Solution A	Solution B
The LED does not come on when unit is plugged in.	No power supplied.	Check to see if plug is secured tightly in outlet and that outlet is working.	
	The accessorial power board and the display board connected failure	Check the connection.	
	The accessorial power board is damaged.	Replace the accessorial power board	
	The display board is damaged.	Replace the display board.	
Some buttons can't work, or the LED display is not normal.	The display board is damaged.	Replace the display board.	
The Cooking Mode Indicator comes on, but heating does not start.	High temperature of the hob.	Ambient temperature may be too high. Air Intake or Air Vent may be blocked.	
	There is something wrong of the fan.	Check if the fan runs smoothly. Fan should be replaced by a new one if not work anymore.	
	The power board is damaged.	Replace the power board.	

7

Failure	Problem	Solution A	Solution B
Heating stops suddenly during operation and display “ <u>u</u> ”.	Pan Type is wrong.	Use the proper pot (refer to the instruction manual.)	Pan detection circuit is damaged, replace the power board.
	Pot diameter is too small		
	Cooker has overheated;	Unit is overheated. Wait	
		for temperature to return to normal. Push “ON/OFF” button to restart unit.	
Heating zones of the same side (Such as the first and the second zone) would display “ <u>u</u> ” .	The power board and the display board connected failure;	Check the connection.	
	The display board of communicate part is damaged	Replace the display board.	

	damaged.		
	The power board is damaged.	Replace the power board.	
Fan motor sounds abnormal.	The fan motor is damaged.	Replace the fan.	