

| | | |
|---------|----|---------------|
| VERSION | 00 | First version |
| | | |

| | |
|-----------------------------|--|
| Document N. | FRN-SB2009-01-modification of the outer door glass |
| Brand | Smeg |
| Models concerned | All models equipped with inner door p/n: 352050798, 482050859, 482050860. <i>N.B. refer to the exploded views to identify the involved models.</i> |
| Cause | The opened door interferes with the lower area of the furniture |
| Description of modification | The outer door glass height has been reduced by 2mm and the fixing points have been moved on the inner door. The 2 spacers p/n 062810805 have been eliminated. |
| Date of introduction | Starting from December 2008 <i>N.B. refer to the exploded views to identify the models, the precise date of introduction and the correct part numbers.</i> |
| Interchangeability | YES – following the instructions hereafter. |

N.B. the current document cancel and replace the document: “FRN-SB2008-11”

➤ NEW CONFIGURATION

Owing to the upon mentioned improvements, the following modifications have been put into practice:



- outer door glass height has been reduced by 2mm
- modification of the outer door glass fixing points which have been moved on the inner door

The appliances produced after the modification are equipped with the new inner door and new outer door glass to avoid the possible interference between door and furniture.

N.B refer to the exploded views to identify the models, the precise date of introduction and the correct part numbers.

➤ OLD CONFIGURATION

For appliances produced before the modification, it is possible to fit the new outer door glass on the original inner door using the proper stirrups:

| P/N 068251052 LEFT GLASS SUPPORTING STIRRUP | P/N 068251051 RIGHT GLASS SUPPORTING STIRRUP |
|---|--|
|  |  |

N.B. these stirrups can be used for all the inner door and outer door glass involved with the modification.

Hereafter the Inner door part numbers where to fit the new outer door glass + 2 stirrups :

352050798 INNER DOOR SM MR SC381X
 482050859 INNER DOOR SM GS SC399X
 482050860 INNER DOOR SM GS PIRO

N.B. refer to the exploded views to identify the models, the precise date of introduction and the correct part numbers.

To properly fit the stirrups proceed as following;

INSTALLATION OF THE NEW OUTER DOOR GLASS+ STIRRUPS ON THE OLD INNER DOOR

The following sequence shows the procedure on a right hinge. Repeat the same procedure for the left hinge.



1. Remove the inner and middle glass/es and unscrew the lower screw fixing the hinge.



2. Remove the second screw fixing the hinge below the inner glass.

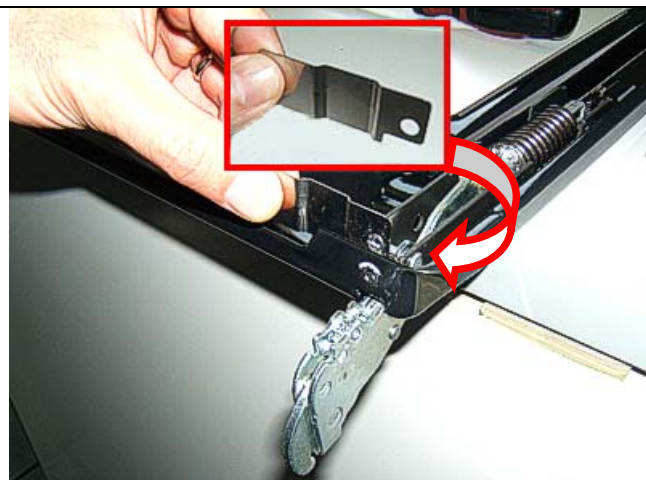

3. Slightly slide the hinge to fit the stirrup between the the hinge and the inner door.
 p/n 068251051 right side



4. Screw the hinge + stirrup on the inner door.



5. Screw the second fixing point of the hinge.



6. WRONG OUTER DOOR GLASS POSITION



7. CORRECT OUTER DOOR GLASS POSITION (inside the new stirrup)



8. Fix the outer glass on the new stirrup.



9. Position once again the middle glass and ...



10. ...the inner glass.