

青岛兴邦电子电器有限公司

说明书

客户名称	新西兰EISNO	设计	韩同骁
业务经理	薛孝田	审核	林建宁
产品类型	THR60	批准	
设计时间	2009.07.14	版次	01

备注：

- 1. 电子文档排版为**A4**纸
- 2. 说明书的最终成品大小为**A4**纸的一半; 折叠成册
- 3. 要求颜色准确, 字迹清晰, 不得有漏印, 错印, 模糊现象
- 4. 此印刷品专用号Cod:0103074036 .
- 5. 此印刷品自订单号 DD090714WDS337开始实施.

(注: 此页为非印刷页, 仅为了说明)



Cooker Hood

Model THR60

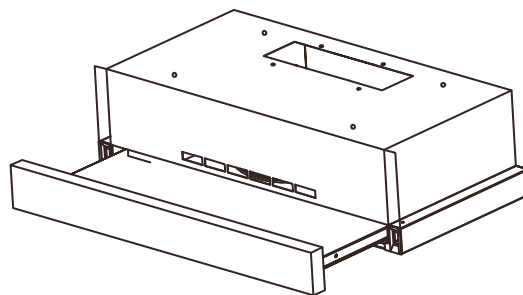

Instruction Book

Cod:0103074036

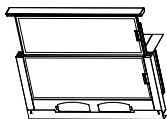

Information and advice

In certain circumstances electrical appliance may be a danger hazard.

A) There shall be adequate ventilation of the room when the cooker hood is used at the same time as appliances burning gas or other fuels.

B) Do not check the status of the filters while the cooker hood is operating.

C) Do not touch the light bulb within half an hour after appliance use.

D) Do not flambe under the cooker hood.

E) Avoid opening gasometer when there is no pan on the stove , as it is damaging for the filters and a fire hazard

F) Constantly check food frying to avoid that the overheated oil may become a fire hazard.

G) Disconnect the electrical plug prior to any maintenance.

H) Regulations concerning the discharge of air have to be fulfilled.

I) When the range hood and appliances supplied with energy

Other than electricity are simultaneously in operation.

The negative pressure in the room must not exceed 4 Pa (4×10^{-5} bar)⁵

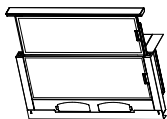

Know your cooker hood

Please read these instructions before using your cooker hood

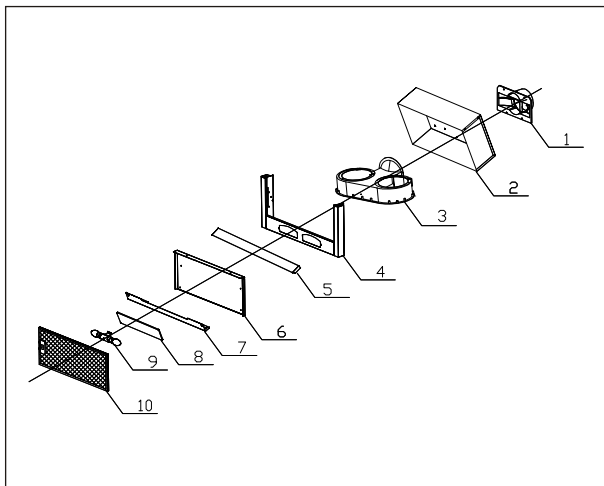

- 1. Outing adaptor
- 3. Air duct assembly
- 5. Front panel
- 7. Sustain board
- 9. Light assembly

- 2. Main body
- 4. Outside frame
- 6. Telescopic board
- 8. Glass
- 10. Filter



Information

Congratulations on the purchase of our Cooker hood, which is designed to include many superior features that permit you the fullest expression of your living. Before installing and/or using the cooker hood carefully read all the instructions.

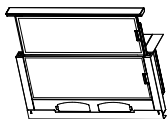

Information and advice

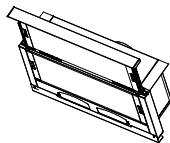

Rating plate

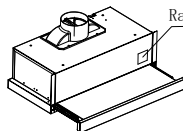

1

Check voltage and frequency given on the rating plate located on the inside of the hood.

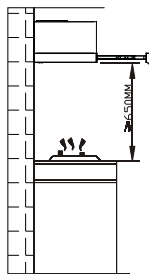

2

We recommend that after installation the bottom of the hood should be no less than 650mm and no more than 750mm above the stove's heating elements and burners.



Information

The air must not be discharged into a flue that is used for exhausting fumes from appliances burning gas or other fuels (not applicable to appliances that only discharge the air back into the room)

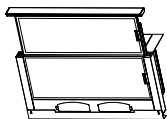

Installation

Ensure the power has been turned off before beginning this installation.

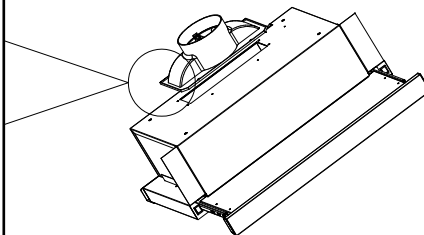
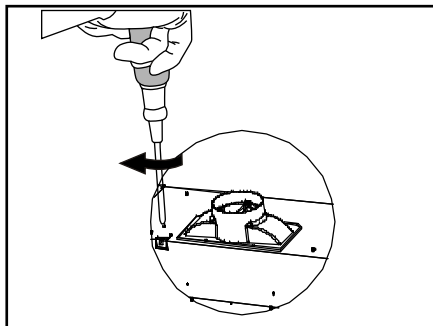

3

Before installing the cooker hood, please first fix the damper flap on the air outlet of the hoods.



Information

Connect universal hose, easy selecting the venting direction

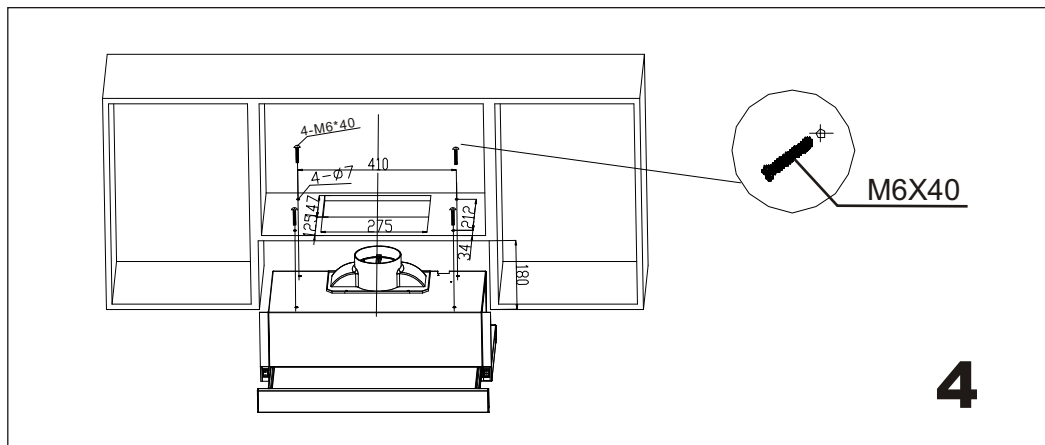

According to the Fig.4, make sure the position of the hoods on the cabinet. Then use the stencil to drill four $\Phi 7$ holes on the cabinet. Fix four sets expanding plugs and screws aimed at the four holes.

The best distance between the bottom of machine and the cabinet on two sides should be less than 2mm. You should make sure that there is no distance between the upside and the cabinet, the gap to the back should be not more than 10mm, the plug should be easy to touch, then it will be easy to be assembled.



Information

When cutting or drilling into wall or ceiling, do not damage electrical wiring or other hidden utilities.

The cooker hood is fully convertible for different venting direction.

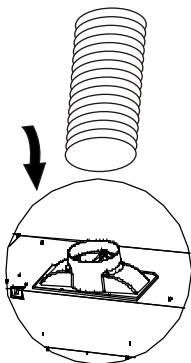

Connect the hose(not supplied)
with the air duct.

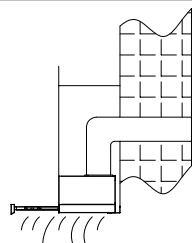

Vertical is the most common. If
your kitchen has an attic space
above, the ducting may be
run up through the cupboard
and attic to a roof cap.

i

Information

*The air must
not be
discharged
into a flue
that is used
for
exhausting
fumes from
appliances
burning gas
or other
fuels.*

Controls:

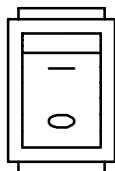

Lamp switch

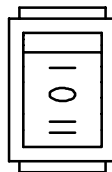

Motor switch

7



Information

Do not touch the light bulb within half an hour after appliance use.

The lamp shall not be covered with thermal insulation or other material.

The telescopic board controls electrical power, just pulling out of the telescopic board, the hood can get electronic power, pull into of the telescopic board, the hood has no power;

And then, both side and under the front panel is both switches for lamp and motor. The lamp switch: Press the switch button on “0”, the lamp is not light; Press the switch button on “I”, the lamp is light; The others side, it is the switch of motor: “0” is not working position; Press the switch button on “I”, the motor runs at the low speed; Press the switch button on “II”, the motor runs at the high speed.

If the supply cord is damaged, it must be replaced by the manufacturer its service agent or similarly qualified persons in order to avoid a hazard.

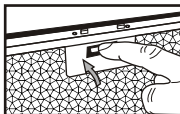
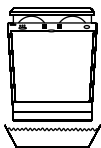
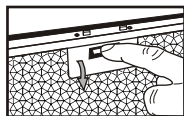

8



Replacing lamp

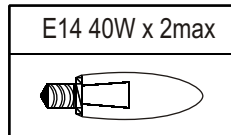
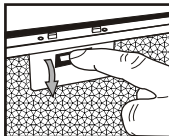

- It is recommendable to clean the metallic filter every three months by carrying out the following instructions:
 - Remove the metallic filter from the cooker hood and wash it in a solution of water and neutral liquid detergent, leaving to soak
 - Rinse thoroughly with warm water and leave to dry.
 - The metallic filter may also be washed in the dishwasher.The metallic filter may alter in color after several washes. This is not cause for customer complaint nor replacement of metallic filter.



Information

There is a fire risk if cleaning is not carried out in accordance with the instructions.

The manufacturer shall decline all responsibility if the foregoing recommendations and instruction regarding installation, maintenance and use are not observed and respected when using the cooker hood.
